

Mikron HSMxxxU TNC530

Machine tool support kit for NX CAM and CAM Express

fact sheet

Siemens PLM Software

www.siemens.com/nx

► Summary

A machine tool support kit is a package consisting of post-processor, simulation driver, machine tool model, CAM templates, documentation, etc. that enables out of the box post processing and simulation for a specific machine tool using NX™ CAM or CAM Express software. This machine tool support kit is tailored for the Mikron HSM x00U Series 5 axes dual table milling machine tool.

Content of the machine tool support kit:

- Post-processor
- Machine tool driver for simulation
- 3D machine tool model
- Machine specific NX CAM template
- Machine specific NX CAM UDE's
- Example data (part, setup, operations)
- Documentation (installation, usage)
- Installation routine (only for Microsoft Windows)

Supported software version

- NX 5

Prerequisites

- NX CAM Base
- NX Post Exec
- ISV – Adv. Simulation

These prerequisites are for example met with the MACH 2, 3 and 4 bundles of NX.

Technology used

- Post-processor: TCL based
- Simulation driver: TCL based
- Simulation support for external NC-Programs (programs containing the same syntax as the programs generated by this machine kit)

Supported machine tool configurations

- Mikron HSM400U with iTNC530 Controller
- Mikron HSM600U with iTNC530 Controller

Unit

- Metric

The supported units influence: post-processor output, simulation driver, contained NX part files.

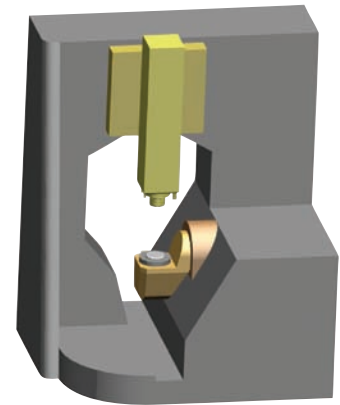

Output and user interface in

- English

Supported capabilities

Kinematics modes

- Cycle19 (5 axis positioning)
- Plane spatial (5 axis positioning)
- M128 (5 axis simultaneous)
- Different kinematics modes in the same program
- Auto detection of needed Kinematics mode upon operation type

NC file types

- Heidenhain conventional language
- Output entire program
- Output sub programs (to be called in a job file on the controller)

General functionality

- TOOL CALL Tool change
- L FMAX Rapid move
- L Fxx Linear move
- CC Circle center
- C DR+/DR- Circular path C around circle center CC , clw / cclw
- BLK FORM Define blank form for graphic workpiece simulation
- TOOL DEF Tool list as comment in the program header
- RL/RR Cutter compensation
- CYCL DEF 9.0/9.1 Delay time
- CYCL DEF 32.0/32.1 Tolerance
- Cycle DEF 19.0/19.1 Working plane

Canned cycle support

- Cycle 201 Reaming
- Cycle 202 Boring
- Cycle 203 Universal drilling
- Cycle 204 Back boring
- Cycle 205 Universal pecking
- Cycle 207 Rigid tapping new
- Cycle 209 Tapping w/chip brkg

▶ Contact

Siemens PLM Software

Americas 800 498 5351

Europe 44 (0) 1276 702000

Asia-Pacific 852 2230 3333

www.siemens.com/plm

SIEMENS